

ATTACHMENT

C

STOREFRONT GRANT
APPLICATION 09-SF-04

REGATTA POINTE MARINA

CRA COMMERCIAL REVITALIZATION GRANT APPLICATION

Regatta Pointe Marina

1005 Riverside Drive

APPLICATION # 09-SF-04

PROJECT SUMMARY

- **Painting of the waterfront office (“Arcade”) buildings \$34,500**
- **Replace/add awnings \$56,985**

Total Improvement Cost: \$91,485.00

Amount of Application: \$45,742.50

Regatta Pointe Marina

Palmetto CRA

Commercial Revitalization Façade Enhancement Grant Program

Application – March 2, 2009

General Project Description – Repainting of the waterfront office (“Arcade”) buildings along with replacement/addition of awnings.

Timeline – Work is in process NOW.

Occupants – VanDerNoord Partners is the owner of Regatta Pointe Marina. Tenants include various local Palmetto businesses and occupants, including Riverside Café, Freedom Boat Club, Dolphin Yacht Sales, Massey Yacht Sales, Inspirations Hair & Spa, Manatee County Sheriff Marine Unit and BoatShedUSA.

Existing Site Information – See sample photos attached.

Cost of Improvements – Cost of improvements are significantly more than the \$50,000 grant limit. Applicant is requesting \$50,000 towards the cost of improvements.

Awnings - \$56,985

Painting - \$34,500 Labor Only. Regatta Pointe Marina to supply material
Material costs could be estimated and added in but grant
limit has already been exceeded. Material Costs are an
estimated \$35,000.

SALES PROPOSAL



PHONE 941-368-7208

100 GILLESPIE AVE
SARASOTA, FL. 34236

FAX 941-368-7208

PROPOSAL SUBMITTED TO:

CUSTOMER NAME: <u>Regatta Pt. Marina</u>	CUSTOMER PHONE:
ADDRESS: <u>1005 RIVERSIDE Da BARNETTO, FL 34221</u>	CELL PHONE: <u>586-0808</u>
SITE NAME: <u>Regatta Pt. Marina</u>	BUSINESS PHONE: <u>721-4013</u>
SITE ADDRESS: <u>SAME</u>	E-MAIL:
	FAX: <u>723-0024</u>

ADDITIONAL INFORMATION:

WE HEREBY SUBMIT THE FOLLOWING SPECIFICATION AND ESTIMATE:

Peter Van Der Noot

- +000-960-09
- +000-960-09
- +000-066-02
- +000-032-042
- +000-056-02

(Quote #1) #'s 1,2,3,4,5,6,9,10,11 → \$25,950⁰⁰ ✓
 (Quote #2) #'s 1,2,3,4,5,6 → \$24,720⁰⁰ ✓
 (Quote #3) #'s, 1 & 2 → \$3,390⁰⁰

These will Be All New Frames / welded Alumin / Powder Coat
 & Some will Have Lettering.

(Retractable)

→ \$6,036.00

~~TOTAL \$60,096.00~~

FABRIC COLOR: <u>Charcoal Twos</u>	DRAW OR DESCRIBE LOCATION OF AWNING ON STRUCTURE:
FABRIC #	(New Price for All)
FABRIC STYLE: <input checked="" type="checkbox"/> SUEDELLA <input type="checkbox"/> VINYL <input type="checkbox"/> OTHER <input type="checkbox"/>	(\$56,985.00)
VALANCE: BRAID	
VALANCE BRAID COLOR:	
FRAME MATERIAL: <u>WELDED ALUMINUM</u>	
FRAME FINISH: <input type="checkbox"/> PAINTED <input type="checkbox"/> POWDER COATED <input checked="" type="checkbox"/> NONE <input type="checkbox"/>	
FRAME COLOR: <u>Match As Close As Possible</u>	
COST OF WORK TO BE PERFORMED:	<input type="checkbox"/> 3-B <input type="checkbox"/> GREEK KEY
MISCELLANEOUS:	<input type="checkbox"/> FLAIR <input type="checkbox"/> 2-B
FRAME FINISH COST:	<input checked="" type="checkbox"/> STRAIGHT <input type="checkbox"/> OTHER
PERMIT:	
TOTAL:	
LESS DEPOSIT:	
BALANCE TO BE PAID TO INSTALL:	

We hereby propose to furnish labor and materials complete in accordance with this sales agreement and any accompanying drawings or check sheets. All materials to be as specified. All work to be done in a workmanlike manner according to standard practices. Any alteration or deviation from specifications become an extra charge over and above this sales agreement. All agreements contingent upon cities, accidents, or delays beyond our control. Owner to carry fire, storm and other necessary insurance. Our workers are covered by Workman's Compensation Insurance. All products or materials delivered or installed on customer's property remains the property of United States Awning Co. until final payment is received. There will be a late charge of 1 1/2% per month starting 30 days after installation. If a lawyer is retained to collect the bill, customer shall pay a reasonable attorney fee.

DATE 6-11-08 SALES-MANAGER [Signature]
 DATE 6/20/08 CLIENT [Signature]

Peter Van Der Noot

Regatta Row - West

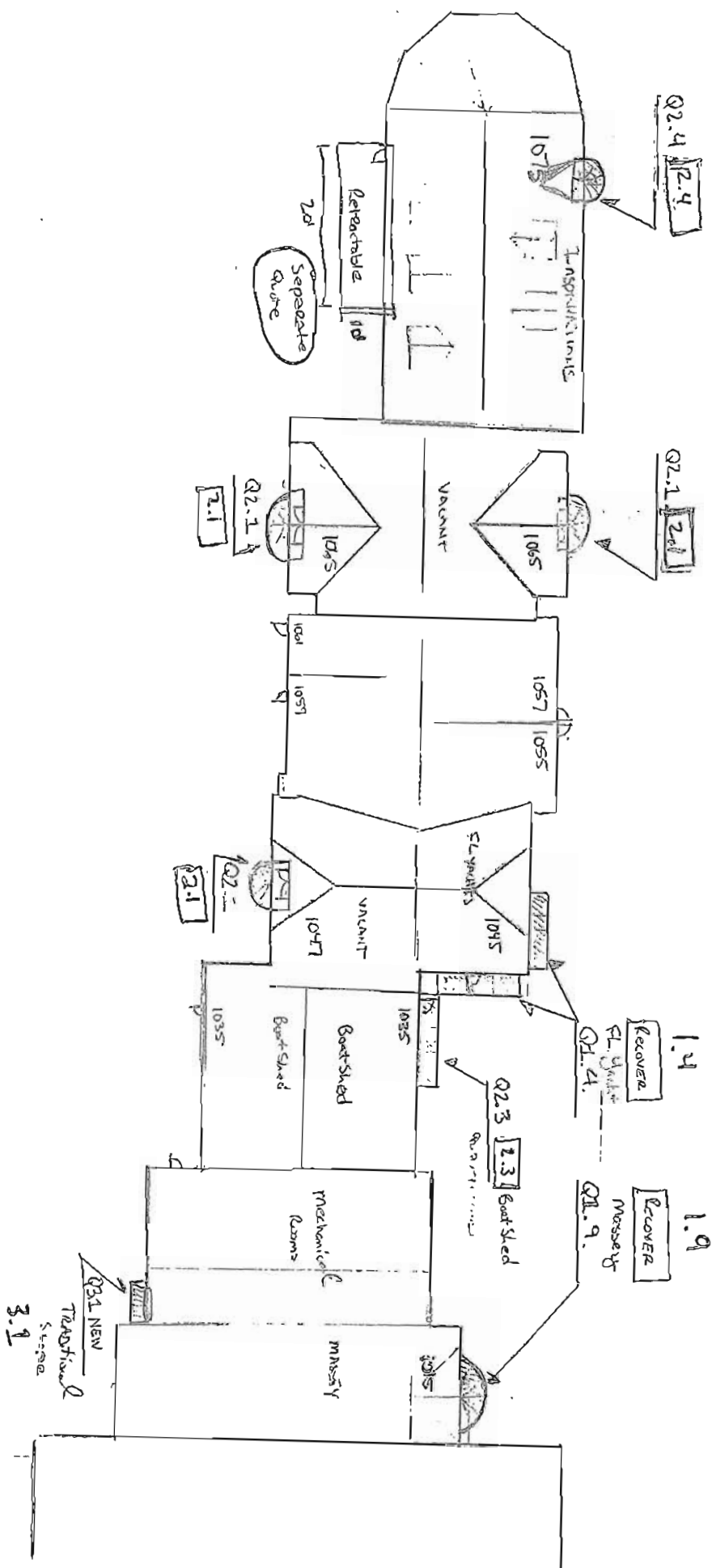

Leighton Roof - East

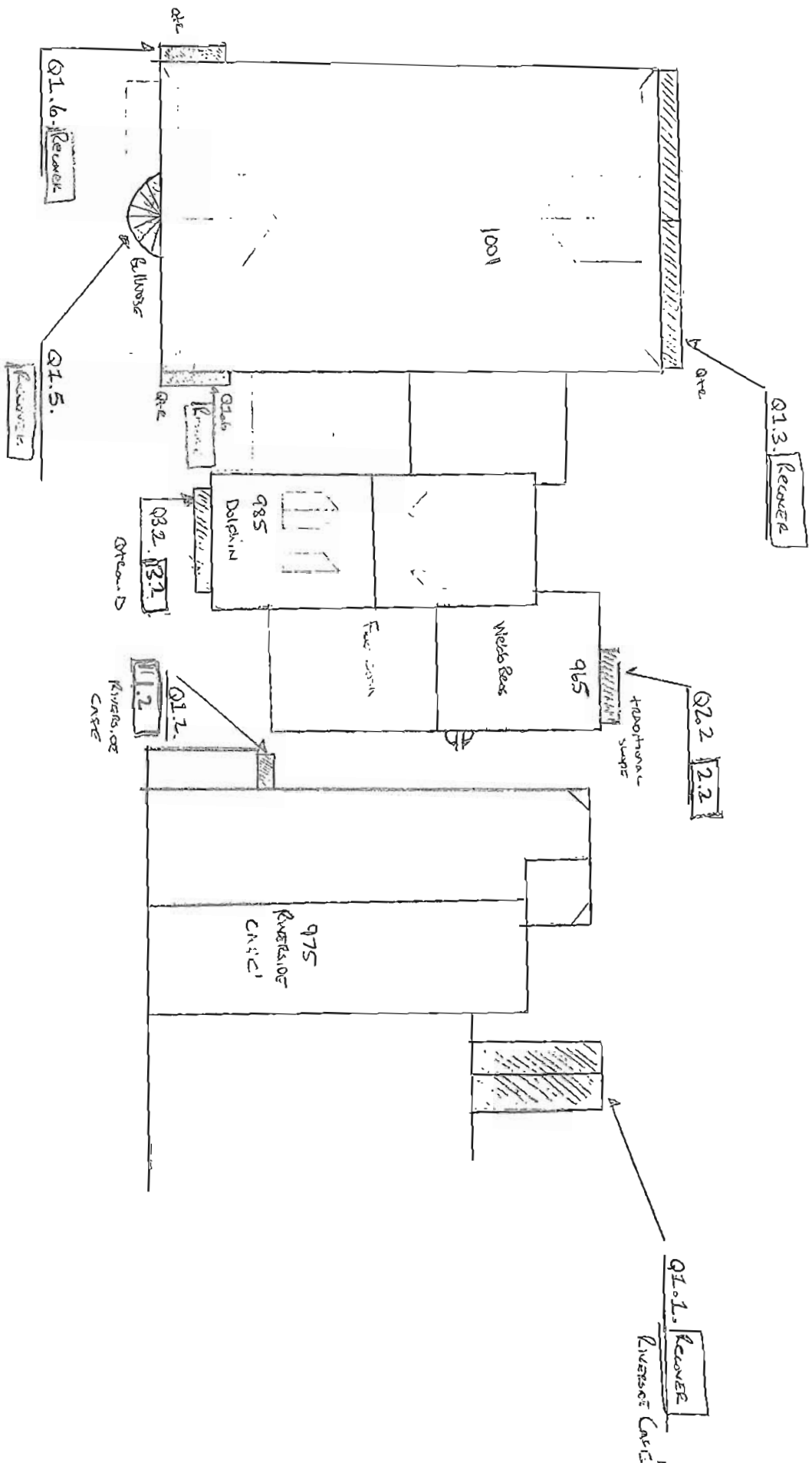

#1

SALES PROPOSAL



PHONE: 941-955-7000

FAX: 941-366-7206

100 GILLESPIE AVE
SARASOTA, FL. 34236

PROPOSAL SUBMITTED TO: Regatta Pointe Marina / (Peter Vander Noord)
CUSTOMER NAME: Regatta Pt Marina CUSTOMER PHONE:

ADDRESS: 1001 Riverside Dr. / PALMETTO FL. 34221 CELL PHONE: 566-0808

JOB SITE NAME: REGATTA PT. MARINA BUSINESS PHONE: 721-4013

SITE ADDRESS: SAME E-MAIL:

FAX: 723-0024

ADDITIONAL INFORMATION: (All Repairs to Existing Frames) (Also Lettering)

WE HEREBY STATE THE FOLLOWING SPECIFICATION AND ESTIMATE:
② - Fabric Awning Recoveries & ① new Frame & Cover / & Repair Frames where needed

- #1- Riverside Cafe Ext. Canopy w/ Lettering
- #2- " " " " " "
- #3- W. Side Front main entrance / ③ Quarter rounds BUILT TOGETHER
- #4- ③ Quarter rounds / FL. YACHT w/ Lettering
- #5- Bollwase - So Side and FL. window / MAIN BLDG.
- #6- ③ Quarter rounds / So Side and FL. MAIN BLDG. ① East and ① West W.
- #7- ① " " " 1ST FL. Rental Space
- #8- ① " " " " " ALL NEW FRAMES & COVER TO MATCH
- #9- ① Bollwase / Massey Yacht Sales' Service \$1,375 Sunbrella
- #10- ① 2nd FL. Canopy - Bridge House \$9,700 Powder Coat
- #11- ① 1ST FL. Awning - Fuel House

make 1
→

avoid
=

\$14,875⁰⁰
\$25,950

From Client:

- ① Includes Installation
- ② MATERIAL - shelter like, black
- ③ MAKE 1 of the #4's to see if we like color & quantity before proceeding w/ re

FABRIC COLOR: <input checked="" type="checkbox"/> Charcoal / <input type="checkbox"/> White	DRAW OR DESCRIBE LOCATION OF AWNING ON STRUCTURE:
FABRIC #:	Painting of Frames & by others
FABRIC STYLE: SUBRELLA <input type="checkbox"/> VINYL <input type="checkbox"/> OTHER <input type="checkbox"/>	↑ By Client <u>powd.</u>
VALANCE: BRAID	
VALANCE BRAID COLOR:	
FRAME MATERIAL: WELDED ALUMINUM	
FRAME FINISH: PAINTED <input type="checkbox"/> POWDER COATED <input type="checkbox"/> NONE <input type="checkbox"/>	
FRAME COLOR:	
COST OF WORK TO BE PERFORMED:	<input type="checkbox"/> 3-B <input type="checkbox"/> GREEK KEY
MISCELLANEOUS:	
FRAME FINISH COST:	<input type="checkbox"/> FLAIR <input type="checkbox"/> 2-B
PERMIT:	<input type="checkbox"/> STRAIGHT <input type="checkbox"/> OTHER
TOTAL: 4326/16	
LESS DEPOSIT:	
BALANCE TO BE PAID TO INSTALL:	

We hereby propose to furnish labor and materials complete in accordance with this sales agreement and any accompanying drawings or check sheet materials to be as specified. All work to be done in a workmanlike manner according to standard practices. Any alteration or deviation from specific to become an extra charge over and above this sales agreement. All agreements contingent upon strikes, accidents, or delays beyond our control. Owners carry fire, storm and other necessary insurance. Our workers are covered by Workman's Compensation Insurance. All products or materials delivered & installed on customer's property remains the property of United States Awning Co. until final payment is received. There will be a late charge of 1 1/2% p month starting 30 days after installation. If a lawyer is retained to collect the bill, customer shall pay a reasonable attorney fee.

DATE 4-21-08 SALES MANAGER
DATE 5-6-08 CLIENT PETER VANDER NOORD, Regatta Pointe

\$25,950 P38

#1 Powder Coat upcharge

SALES PROPOSAL

UNITED STATES AWNING CO.

100 GILLESPIE AVE
SARASOTA, FL 34236

PHONE: 941-366-7200 FAX: 941-366-7206

PROPOSAL SUBMITTED TO:

CUSTOMER NAME: Regatta Pointe MARINA CUSTOMER PHONE: _____

ADDRESS: 1001/1005 EVERSIDE DR PALMETTO, FL 34221 CELL PHONE: 586-0808

JOB SITE NAME: Regatta Pointe BUSINESS PHONE: 721-4013

SITE ADDRESS: SAME E-MAIL: _____

FAX: 723-0024



ADDITIONAL INFORMATION:

WE HEREBY SUBMIT THE FOLLOWING SPECIFICATION AND ESTIMATE:

SAND BLAST & POWDER COAT ALL EXISTING FRAMES
(MARINE GRADE)

(PER VANDERHOOD)

(\$9,700⁰⁰)

FABRIC COLOR:	DRAW OR DESCRIBE LOCATION OF AWNING ON STRUCTURE:
FABRIC #:	
FABRIC STYLE: <input type="checkbox"/> SUBRELLA <input type="checkbox"/> VINYL <input type="checkbox"/> OTHER <input type="checkbox"/>	
VALANCE: BRAID	
VALANCE BRAID COLOR:	
FRAME MATERIAL: WELDED ALUMINUM	
FRAME FINISH: <input type="checkbox"/> PAINTED <input checked="" type="checkbox"/> POWDER COATED <input type="checkbox"/> NONE	
FRAME COLOR: <u>2</u>	
COST OF WORK TO BE PERFORMED	<input type="checkbox"/>  <input type="checkbox"/> GREEK KEY <input type="checkbox"/>
MISCELLANEOUS:	<input type="checkbox"/>  <input type="checkbox"/> 2-B <input type="checkbox"/>
FRAME FINISH COST:	<input type="checkbox"/> STRAIGHT <input type="checkbox"/> OTHER
PERMIT:	
TOTAL:	
LESS DEPOSIT:	
BALANCE TO BE PAID TO INSTALL:	

We hereby propose to furnish labor and materials complete in accordance with this sales agreement and any accompanying drawings or check sheets. All materials to be as specified. All work to be done in a workmanlike manner according to standard practices. Any alteration or deviation from specifications will become an extra charge over and above this sales agreement. All agreements contingent upon permits, accidents, or delays beyond our control. Owner to carry fire, storm and other necessary insurance. Our workers are covered by Workman's Compensation Insurance. All products or materials delivered or installed on customer's property remains the property of United States Awning Co. until final payment is received. There will be a late charge of 1 1/2% per month starting 30 days after installation. If a lawyer is retained to collect the bill, customer shall pay a reasonable attorney fee.

DATE: 5-30-08 SALES-MANAGER: [Signature]

DATE: _____ CLIENT: _____

P39

Quote 2 / #2

Includes ALL Frames Powder Coated

REGATTA Pointe

U.S. Awning Co. Ranney, 809-7578

#1 ✓ 1047 (Units # 1065, 1077, 1065)

③ Fabric Bellwase style Awning / Powder Coated Frames

\$4,600⁰⁰



#2 ✓ unit 965 webb Boathrs

① Extra Awning - ~~with lettering~~ w/ Lettering / P. Coated Frames

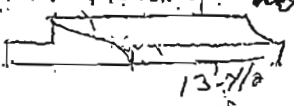

\$1,750⁰⁰

#3 W Unit # 1035 Boat Shed

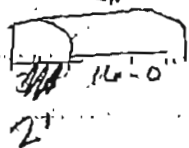

① Quarter Round Awning / P. Coated Frame

\$1,695⁰⁰

Add => Polaris - 4th Row 13' 3"

#4 ✓ HAIR SALON Bellwase style Awning / P. Coated Frame / w/ Lettering (3 Sides)



\$7950⁰⁰



Ships STORE

#5 ① West Elev. Large Canopy 42' w x 10'-8 pros / P. Coated Frame

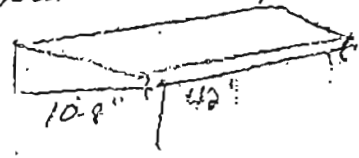

\$12,850⁰⁰

#6 ② Fabric Panels & Frame TO BOLT TO Existing Awning on 2nd F Banquet Room. 2'-0" x 10'-6" / 15'-4" w/ Lettering. P. Coated Frame \$1,875⁰⁰

Prices Do NOT Include any Permits or Engineer Fees Required By City or County

Total 220

ok [Signature] 6/5/08

Quote #3

#1 Maintenance Room Traditional Slope

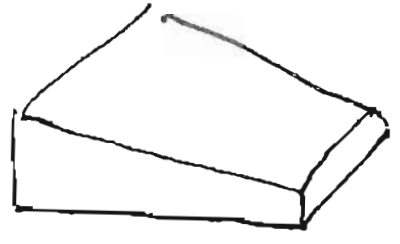

Q3.1.

#2 Dolphin Yachts, ~~North~~ South side,

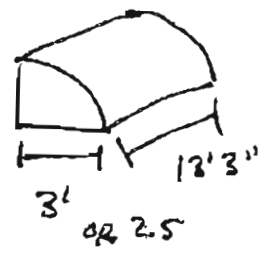

Q3.2.

Per phone call, "option" or "quote" 3 was added & pricing was only reflected on cover summary estimate (Peter Vandervoort & Long Takowak 3/10/09)

\$3,390⁰⁰

UNITED STATES DRAINING CO.

Since 1862

RAINDY BEAVERSON

Sales Manager

1100 Citruspia Ave
Sarasota, FL 34236

PHONE: 941-955-7010

FAX: 941-366-7206

www.usdrainco.com

EMAIL: sales@unitedstatesdrainco.com

PELAGIA POINT

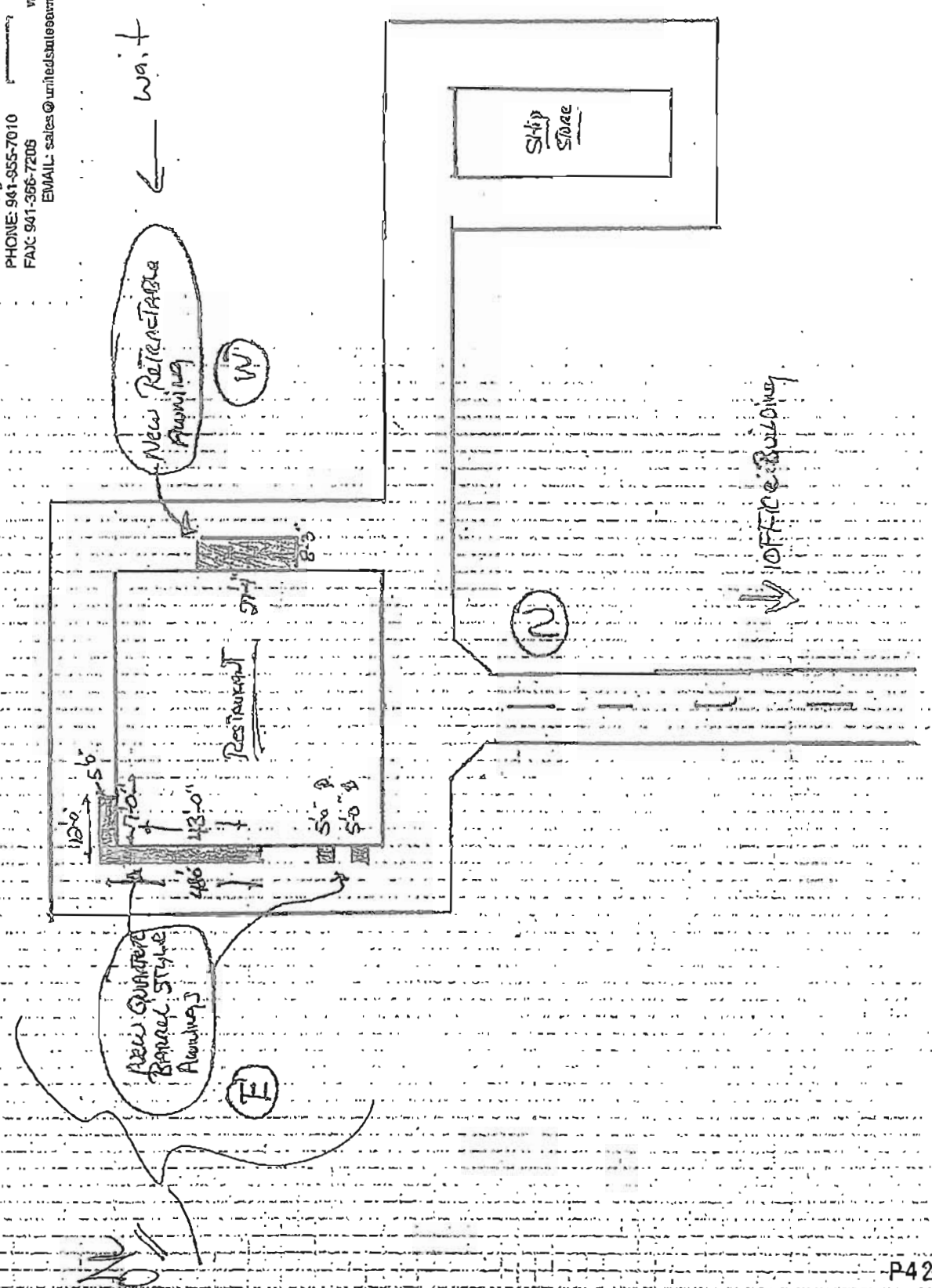

UNITED STATES AWNING CO.

Since 1962

State License #
CBC1255749
RX11066738
OB23879

Phone: (941) 955-7010
FAX#: (941) 388-7208
Web Site: www.usawning.com

DATE: 5/23/2008

Customer: Regatta Pointe Marina
Address: 1001 Riverside Drive
City / St / Zip: Palmetto Fl. 34221
Salesperson: Craig Ervin

Phone #: 721-4013
Cell#: 586-0808
Fax#: 723-0024

Select One "X": Standard Sunesta or SmartCase

Width FT	In	Projection FT	X	Part #	Qty.	Description / Comments	Price Each	Total
20	6	10		Brown				
Frama Color			X	White	1		4,098.00	4,098.00
				Beige				
Mounting Brackets				Wall Brkt. Kit			48.00	0.00
				Ceiling Brkt			78.00	0.00
			X	Roof Brkt Kit	4		148.00	592.00
Drive Side (Facing Awning)				Left or Right			(included)	
			X	Type L or R	R			
Wireless Plug-In Shade				CMO Motor	X	Will need electrician if motor is hard wired into electrical service (not included in the price.)	778.00	778.00
				303050	1			
				Extra Weatherproof Remote			84.00	0.00
				304313				
				Wind Sensor			180.00	0.00
				304305				
				Sun & Wind Sensor			230.00	0.00
				304306				
Hand Crank				4' 0" Length			32.00	0.00
				115215				
				4' 7" Length			34.00	0.00
				115125				
				5' 3" Length			36.00	0.00
				115126				
			X	6' 7" Length	1		40.00	40.00
				115127				
				6' 2" Length			44.00	0.00
				115128				
Protective Hood				Hood			600.00	0.00
				10_045				
				Hood End			32.00	0.00
				11_161				
				Hood Brkt			24.00	0.00
				11_123				
				Hood Splice			28.00	0.00
				111162				
SmartDrop				Fabric Color #			1,260.00	0.00
SmartCase			X	10_224	1		1,008.00	1,008.00

1 Year Warranty on labor from the date of installation

Fabric Information

Deck Fab #	Val Fab. #	Valance Ht (6"-8" LG)	Style	Binding #	Binding Color
364-638	364-388	12"	5	Straight	None

Sub-Total	\$6,514.00
Installation	\$300.00
\$ Discount	-778.00
% Discount	
Total	6,036.00

Installed in 14 Working Days

Down Payment **3,018.00**

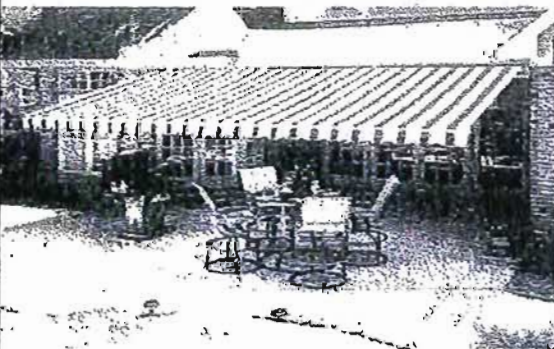
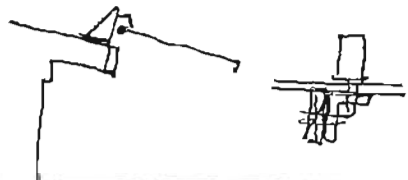
Location	Notes and Comment
	<p>Unit mounts on roof Client to remove wood soffit for our installation of truss angles. All brackets will be sealed and stainless bolts to be used</p> 

We hereby propose to furnish labor and materials complete in accordance with this sales agreement and any accompanying drawings or check sheets. All materials to be as specified. All work to be done in a workmanlike manner according to standard practices. Any alteration or deviation from specifications will become an extra charge over and above this sales agreement. All agreements contingent upon strikes, accidents, or delays beyond our control. Owner to carry fire, storm and other necessary insurance. Our workers are covered by Workman's Compensation Insurance. All products or materials delivered or installed on customer's property remain the property of United States Awning Co. until final payment is received. There will be a late charge of \$75 per month starting 30 days after installation. If a lawyer is retained to collect the bill, customer shall pay a reasonable attorney fee.

Customer: [Signature]
Sales Manager: Craig Ervin

Date: 6/5/08
Date: 5/23/08

Tony Whitfield Painting
3858 Gopher Street
Sarasota, FL 34232
941-780-4087

ESTIMATE

CUSTOMER
Regatta Pointe Marina
1005 Riverside Drive
Palmetto, FL 34221

DATE 1/1/08

PROJECT Repainting offices at Regatta Pointe Marina to "Island Yellow"

Tony Whitfield Painting hereby proposes to furnish all labor and/or labor to complete to following above project, subject to the terms of this ESTIMATE. All work shall be paid on a minimum 2 week draw schedule and all final bills due within 30 days of submission. All work to be done in a workmanlike manner according to standard practices.

We hereby submit the following specifications and estimate:

Prep and repaint the waterfront office building at Regatta Pointe Marina (16,000 square foot, approximate, single-story wood structure). Estimate is for LABOR ONLY.

Customer to provide all primer, paint, sealers, caulk, etc. per their specs.

Estimate shall include one coat of PRIMER and TWO finish coats.

Estimate shall include all of the wall surfaces along with eaves and fascia.

Estimate does NOT include any replacement of wood or other materials.

COST ESTIMATE: \$34,500 LABOR

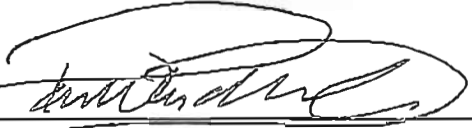
Accepted by: 

Date: 1/15/08

For: Peter Van Der Noot, President
Regatta Pointe Marina

PARID: 3122100005
FLORIDA STATE OF

955 RIVERSIDE DR



Manatee County

Ord 567/568

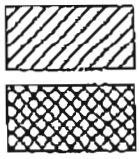
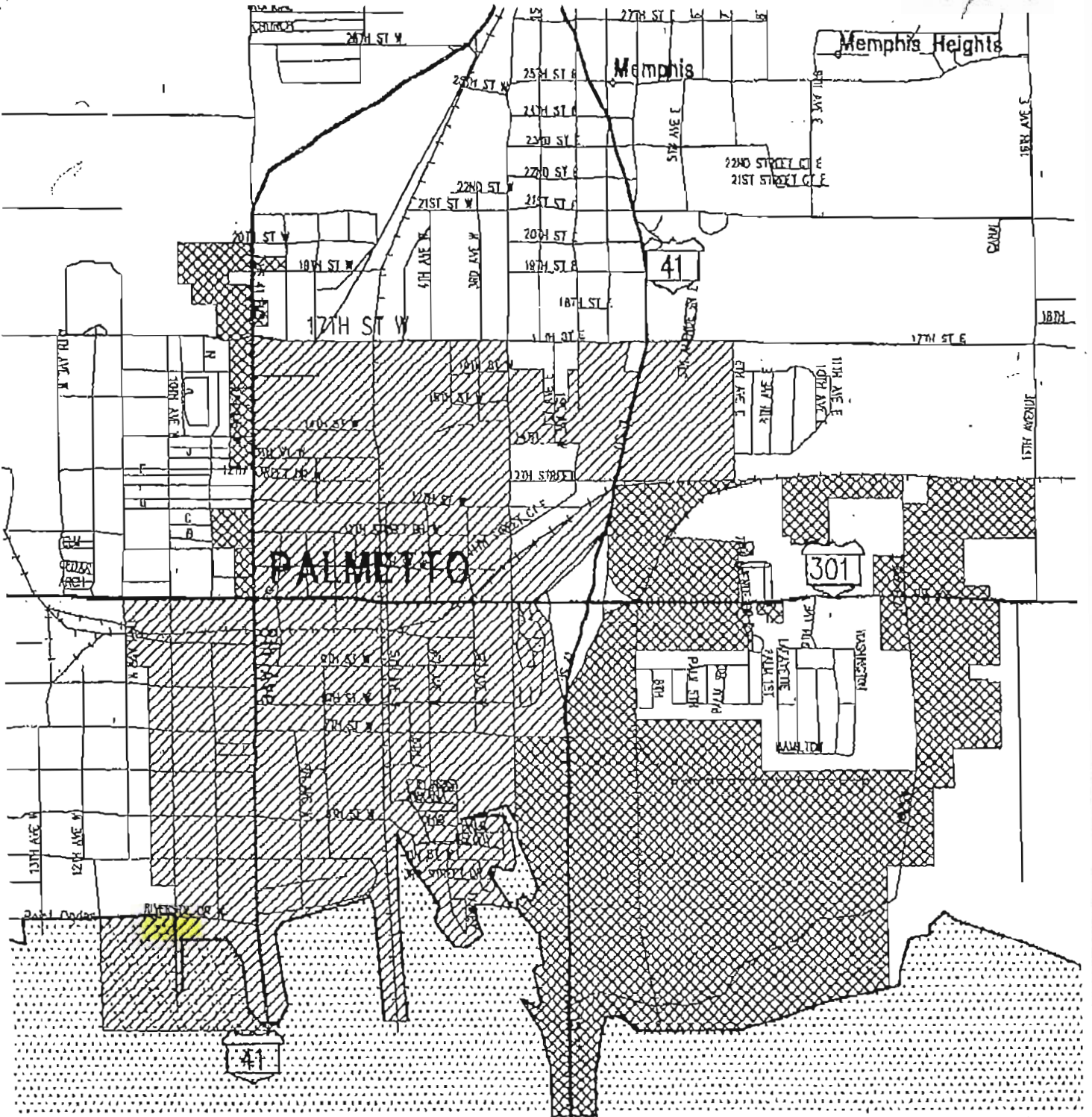

EXISTING CRA DISTRICT

PROPOSED CRA DISTRICT EXPANSION

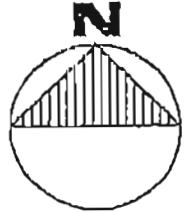

Palmetto CRA 2007 . Primary Bump
Use
Code
2001

Parcel ID	House Number	Street Name	Street Type1	Street Type2	Dir	Street Number	Unit	Owner name	Code
3121500007	1005	RIVERSIDE	DR					FLORIDA STATE OF	2001