

TAB 3



City of Palmetto Agenda Item

Meeting Date

9/10/2012

Presenter: Jeff Burton

Department: CRA

Title: Sutton Park play area

Program Goal: Continued improvements to Sutton Park to remove blight conditions.

Program Summary: Per City Commission direction, the Palmetto CRA has developed a Sutton Park play area conceptual plan that includes:

- Fencing that separates the play area from 6th Street
- Rubber mulch instead of sand
- Multiple shade benches
- Lighting
- Walkways
- Additional play area amenities

See attached conceptual plan and budget.

Funding: Funds have been allocated in the budget for this program. Construction may be gained from a scope change to the existing Sutton Park Phase 1 contract or RFP.

Budgeted Amount:	\$215,000.00	Budget Page No(s):		Available Amount:	\$250,000.00	Expenditure Amount:	\$215,000.00
-------------------------	--------------	---------------------------	--	--------------------------	--------------	----------------------------	--------------

Additional Budgetary Information: Funds are budgeted for this project.

Funding Source(s):	2011-12 Budget	Sufficient Funds Available:	<input checked="" type="checkbox"/> Yes <input type="checkbox"/> No	Budget Amendment Required:	<input type="checkbox"/> Yes <input checked="" type="checkbox"/> No	Source:	FY 2012
---------------------------	----------------	------------------------------------	--	-----------------------------------	--	----------------	---------

City Attorney Reviewed:	<input type="checkbox"/> Yes <input type="checkbox"/> No <input type="checkbox"/> N/A	Advisory Board Recommendation:	<input checked="" type="checkbox"/> For <input type="checkbox"/> Against <input type="checkbox"/> N/A	Consistent With:	<input checked="" type="checkbox"/> Yes <input type="checkbox"/> No <input type="checkbox"/> N/A		FS 163 CRA Plan Comp Plan
--------------------------------	---	---------------------------------------	---	-------------------------	--	--	---------------------------------

Potential Motion/ Direction Requested:

Motion A: Move to approve Sutton Park play area conceptual plan and amend current Stellar Development contract to change the scope to include Sutton Park play area not to exceed \$215,000.00 with a \$35,000.00 construction expenditure account.

Or

Motion B: Move to approve Sutton Park play area conceptual plan and direct Staff to administer a Request for Proposal (RFP) for construction.

Staff Contact: Jeff Burton CRA Director

Attachments: Conceptual Plan
Estimated Budget

Sutton Park - Playground
 Cost Breakdown

Item Description	Price
General Conditions/Management	\$ 23,681.25
Project Manager	
Superintendent	
Temporary fencing	
Surveying	
Misc. General Conditions	
Demolition/Site work	\$ 10,941.75
Walkways and Benches	\$ 52,701.08
Electrical	\$ 68,904.06
Light Fixtures	
Light Pole bases	
200 amp service and wiring	
Fencing	\$ 20,241.69
Rubber Mulch	\$ 31,549.45
6" deep (80,000lbs)	
Playground Equipment	\$ 6,953.72
New Swing Set	
New Tire Swing	
Total	\$ 214,973.00

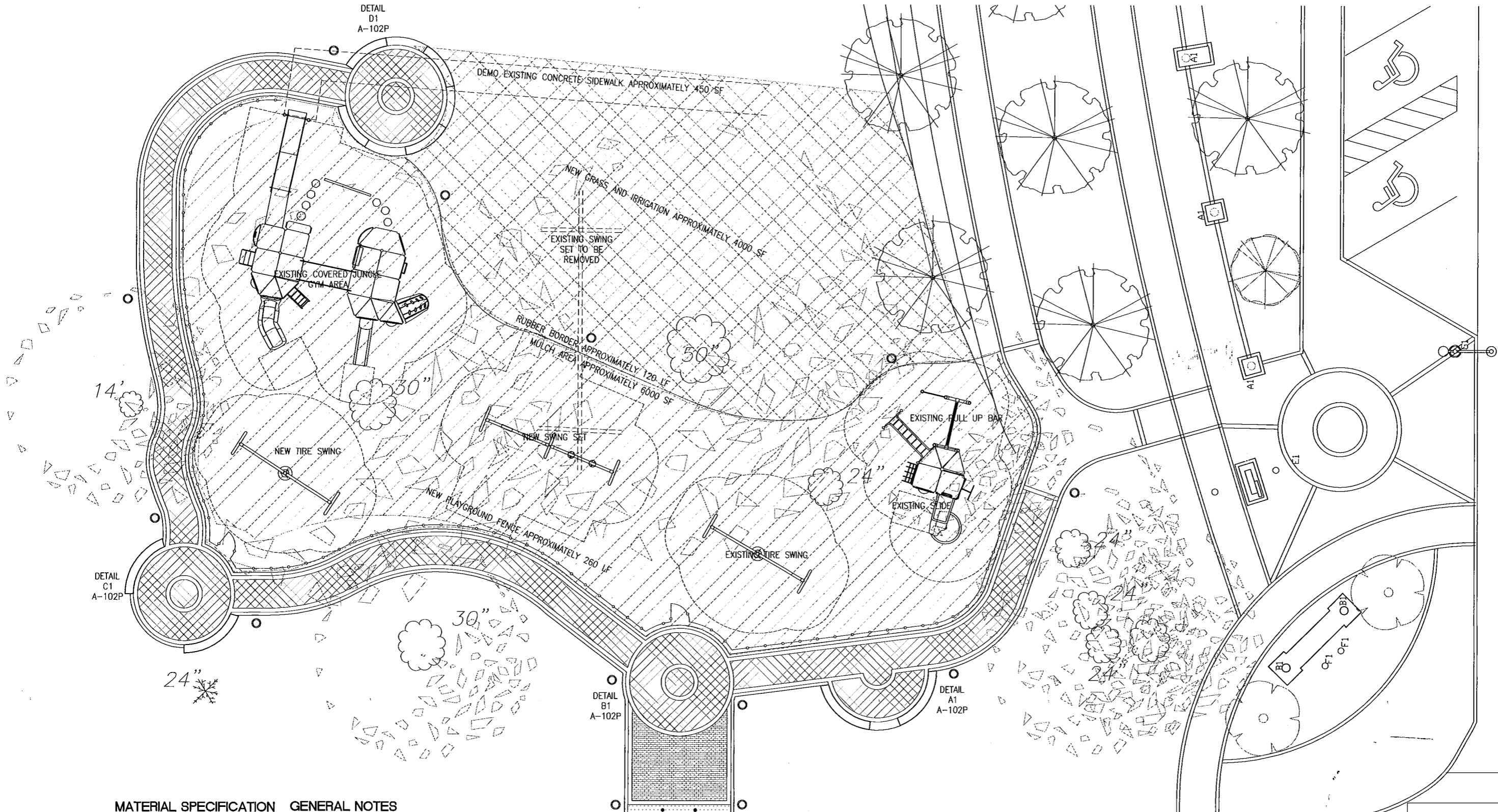

DETAIL
D1
A-102P

DETAIL
C1
A-102P

DETAIL
B1
A-102P

DETAIL
A1
A-102P

MATERIAL SPECIFICATION

GENERAL NOTES

1. RUBBER PLAYGROUND MULCH TO BE 99% WIRE FREE 6" DEEP BY RMPUSA OR EQUAL.
2. RUBBER PLAYGROUND BORDER TO BE RMPUSA BD-688 OR EQUAL.
3. EXISTING SWING SET TO BE REMOVED BY CITY.
4. NEW FENCE TO BE 4" HIGH ALUMINUM POWDER COATED DARK BRONZE #403 CAROLINA CUSTOM MODIFIED WITH 4" RINGS 1" PICKET 2" SQ. TOP AND BOTTOM RAILS 3" SQ X .125 X 72" DIRECT BURY POST WITH CUSTOM CAPS BY IDEAL FENCE OR EQUAL. MATCHING GATES TO BE SELF CLOSING WITH LATCH ABOVE 42".
5. PROVIDE FULL SIZE BRICK ON SLOPED WALLS BY ROBINSON BRICK COLOR TO BE CITY HALL BENCH TOP TO BE 1-1/2" THICK, PINE HALL BULL NOSE BRICK IN DARK ACCENT SOLDIER COURSE TO BE 2-1/4" THICK, PINE HALL STORM PAVE BRICK IN DARK ACCENT.
6. 12" X 12" 2-3/8" THICK PAVERS TO BE TREMOR, PARK PLAZA SERIES CONCRETE PAVERS IN SAND DUNE.
7. PAVERS TO 6TH STREET TO BE RECYCLED PAVERS SUPPLIED BY OWNER RUNNING BOND PATTERN.
8. ADA PAVERS AT 6TH STREET TO BE PINE HILL TRUNCATED DOMES TO MATCH EXISTING.

1. FIELD ADJUST CONCRETE RIBBON CURB/EDGE RESTRAINT HEIGHT TO ALLOW POSITIVE DRAINAGE & 6" OF MULCH FOR PLAYGROUND.
2. RIBBON CURBS TO HAVE 1/2" V TOWELED JOINT AT 48" OC.
3. 12"X12" PAVERS TO BE CENTERED IN CIRCULAR AREAS.
4. CHAMFER ALL EXPOSED CONCRETE EDGES 1/2".
5. ELECTRICAL CONDUIT SIZES UNLESS OTHERWISE NOTED:
 - 5.1. LIGHTING 1"
 - 5.2. DUPLEX RECEPTACLE 1"
 - 5.3. FUTURE USE 2"

PROVIDE AN ADD ALTERNATE PRICE FOR INSTALLING OWNER SUPPLIED BRICK PER DETAIL SHEET P3 PERVIOUS PAVEMENT BRICK APPROXIMATELY 500 SF

A1 PLAYGROUND SITE PLAN
SCALE 1/8" = 1'-0"

PRELIMINARY NOT FOR CONSTRUCTION

PLAYGROUND SITE PLAN

SUTTON PARK RESTROOMS

A-100-P

SHEET NO.

PROJECT NO. DATE
 1208 06/27/2012

PALMETTO, FL

Moore 2 Design
 ARCHITECTURE - INTERIOR DESIGN
 Architect: Jon L. Moore, AIA AR26001330
 Phone 941.729.1229 Fax 941.729.5979
 706 Riverside Drive Palmetto, FL 34221
COPYRIGHT MOORE 2 DESIGN, LLC. ALL RIGHTS RESERVED

NO.	DATE	REVISION DESCRIPTION
1	08.12.12	ISSUE DATE
2	08.30.12	DESIGN UPDATE

6TH STREET WEST

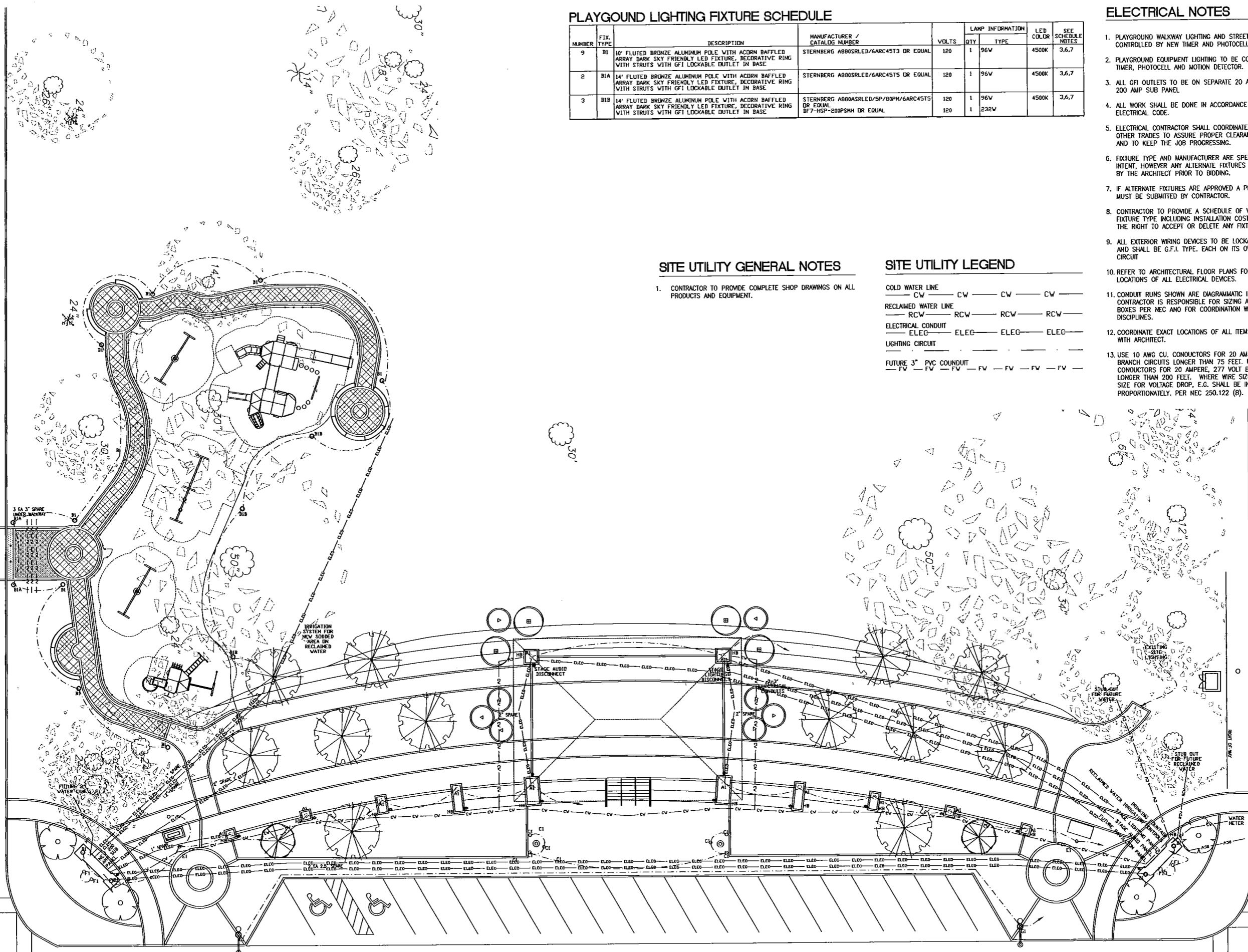

PLAYGROUND LIGHTING FIXTURE SCHEDULE

NUMBER	FIX. TYPE	DESCRIPTION	MANUFACTURER / CATALOG NUMBER	VOLTS	LAMP INFORMATION		LED COLOR	SEE SCHEDULE NOTES
					QTY	TYPE		
9	B1	10' FLUTED BRONZE ALUMINUM POLE WITH ACORN BAFFLED ARRAY DARK SKY FRIENDLY LED FIXTURE, DECORATIVE RING WITH STRUTS WITH GFI LOCKABLE OUTLET IN BASE	STERNBERG A880SRLED/6ARC45T5 DR EQUAL	120	1	96W	4500K	3.6.7
2	B1A	14' FLUTED BRONZE ALUMINUM POLE WITH ACORN BAFFLED ARRAY DARK SKY FRIENDLY LED FIXTURE, DECORATIVE RING WITH STRUTS WITH GFI LOCKABLE OUTLET IN BASE	STERNBERG A880SRLED/6ARC45T5 DR EQUAL	120	1	96W	4500K	3.6.7
3	B1B	14' FLUTED BRONZE ALUMINUM POLE WITH ACORN BAFFLED ARRAY DARK SKY FRIENDLY LED FIXTURE, DECORATIVE RING WITH STRUTS WITH GFI LOCKABLE OUTLET IN BASE	STERNBERG A880SRLED/SP/80PH/6ARC45T5 DR EQUAL DF7-HSP-200PSM DR EQUAL	120	1	96W	4500K	3.6.7
				120	1	232W		

ELECTRICAL NOTES

1. PLAYGROUND WALKWAY LIGHTING AND STREETLIGHTS TO BE CONTROLLED BY NEW TIMER AND PHOTOCELL.
2. PLAYGROUND EQUIPMENT LIGHTING TO BE CONTROLLED BY NEW TIMER, PHOTOCELL AND MOTION DETECTOR.
3. ALL GFI OUTLETS TO BE ON SEPARATE 20 AMP CIRCUITS TO NEW 200 AMP SUB PANEL.
4. ALL WORK SHALL BE DONE IN ACCORDANCE WITH THE NATIONAL ELECTRICAL CODE.
5. ELECTRICAL CONTRACTOR SHALL COORDINATE WORK WITH ALL OTHER TRADES TO ASSURE PROPER CLEARANCES FOR EQUIPMENT AND TO KEEP THE JOB PROGRESSING.
6. FIXTURE TYPE AND MANUFACTURER ARE SPECIFIED FOR DESIGN INTENT, HOWEVER ANY ALTERNATE FIXTURES MUST BE APPROVED BY THE ARCHITECT PRIOR TO BIDDING.
7. IF ALTERNATE FIXTURES ARE APPROVED A PHOTOMETRIC PLAN MUST BE SUBMITTED BY CONTRACTOR.
8. CONTRACTOR TO PROVIDE A SCHEDULE OF VALUES FOR EACH FIXTURE TYPE INCLUDING INSTALLATION COST. OWNER RESERVES THE RIGHT TO ACCEPT OR DELETE ANY FIXTURE TYPE.
9. ALL EXTERIOR WIRING DEVICES TO BE LOCKABLE WEATHERPROOF AND SHALL BE G.F.I. TYPE. EACH ON ITS OWN 20 AMPERE CIRCUIT
10. REFER TO ARCHITECTURAL FLOOR PLANS FOR DIMENSIONAL LOCATIONS OF ALL ELECTRICAL DEVICES.
11. CONDUIT RUNS SHOWN ARE DIAGRAMMATIC IN NATURE. CONTRACTOR IS RESPONSIBLE FOR SIZING AND LOCATING PULL BOXES PER NEC AND FOR COORDINATION WITH OTHER DISCIPLINES.
12. COORDINATE EXACT LOCATIONS OF ALL ITEMS INSTALLED ON SITE WITH ARCHITECT.
13. USE 10 AWG CU. CONDUCTORS FOR 20 AMPERE, 120 VOLT BRANCH CIRCUITS LONGER THAN 75 FEET. USE 10 AWG CU. CONDUCTORS FOR 20 AMPERE, 277 VOLT BRANCH CIRCUITS LONGER THAN 200 FEET. WHERE WIRE SIZE IS INCREASED IN SIZE FOR VOLTAGE DROP, E.G. SHALL BE INCREASED PROPORTIONATELY. PER NEC 250.122 (B).

SITE UTILITY GENERAL NOTES

1. CONTRACTOR TO PROVIDE COMPLETE SHOP DRAWINGS ON ALL PRODUCTS AND EQUIPMENT.

SITE UTILITY LEGEND

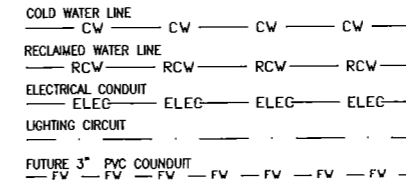

10TH AVENUE WEST

A1 ELECTRICAL PLAN
 NORTH
 SCALE 1/4" = 1'-0"

PRELIMINARY NOT FOR CONSTRUCTION
 PLAYGROUND ELECTRICAL PLAN
 SUTTON PARK RESTROOMS
 PALMETTO, FL
 SHEET NO. E-100-P
 PROJECT NO. 1208
 DATE 06/27/2012

Moore 2 Design
 ARCHITECTURE - INTERIOR DESIGN
 Architect: Jon L. Moore, AIA AR26001330
 Phone: 941.729.1229 Fax: 941.729.5979
 706 Riverside Drive Palmetto, FL 34221
 COPYRIGHT © MOORE 2 DESIGN, LLC. ALL RIGHTS RESERVED

NO.	DATE	REVISION DESCRIPTION
1	08.12.12	ISSUE DATE
2	08.30.12	DESIGN UPDATE

MATERIAL SPECIFICATION GENERAL NOTES

- RUBBER PLAYGROUND MULCH TO BE 99% WIRE FREE 6" DEEP BY RMPUSA OR EQUAL.
 - RUBBER PLAYGROUND BORDER TO BE RMPUSA BD-688 OR EQUAL.
 - EXISTING SWING SET TO BE REMOVED BY CITY.
 - NEW FENCE TO BE 4' HIGH ALUMINUM POWDER COATED DARK BRONZE #403 CAROLINA CUSTOM MODIFIED WITH 4" RINGS 1" PICKET 2" SQ. TOP AND BOTTOM RAILS 3" SQ X .125 X 72" DIRECT BURY POST WITH CUSTOM CAPS BY IDEAL FENCE OR EQUAL. MATCHING GATES TO BE SELF CLOSING WITH LATCH ABOVE 42".
 - PROVIDE FULL SIZE BRICK ON SLOPED WALLS BY ROBINSON BRICK COLOR TO BE CITY HALL BULL NOSE BRICK IN DARK ACCENT.
 - SOLDIER COURSE TO BE 2-1/4" THICK, PINE HALL STORM PAVE BRICK IN DARK ACCENT.
 - 12" X 12" 2-3/8" THICK PAVERS TO BE TREMOR, PARK PLAZA SERIES CONCRETE PAVERS IN SAND DUNE.
 - PAVERS TO 6TH STREET TO BE RECYCLED PAVERS SUPPLIED BY OWNER RUNNING BOND PATTERN.
 - ADA PAVERS AT 6TH STREET TO BE PINE HILL TRUNCATED DOMES TO MATCH EXISTING.
- FIELD ADJUST CONCRETE RIBBON CURB/EDGE RESTRAINT HEIGHT TO ALLOW POSITIVE DRAINAGE & 6" OF MULCH FOR PLAYGROUND.
 - RIBBON CURBS TO HAVE 1/2" V TOWELED JOINT AT 48" OC.
 - 12"x12" PAVERS TO BE CENTERED IN CIRCULAR AREAS.
 - CHAMFER ALL EXPOSED CONCRETE EDGES 1/2" ELECTRICAL CONDUIT SIZES UNLESS OTHERWISE NOTED;
 - LIGHTING 1"
 - DUPLEX RECEPTACLE 1"
 - FUTURE USE 2"

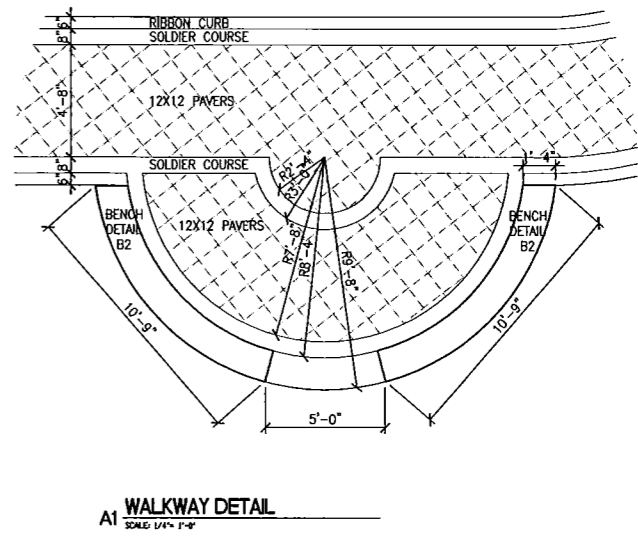
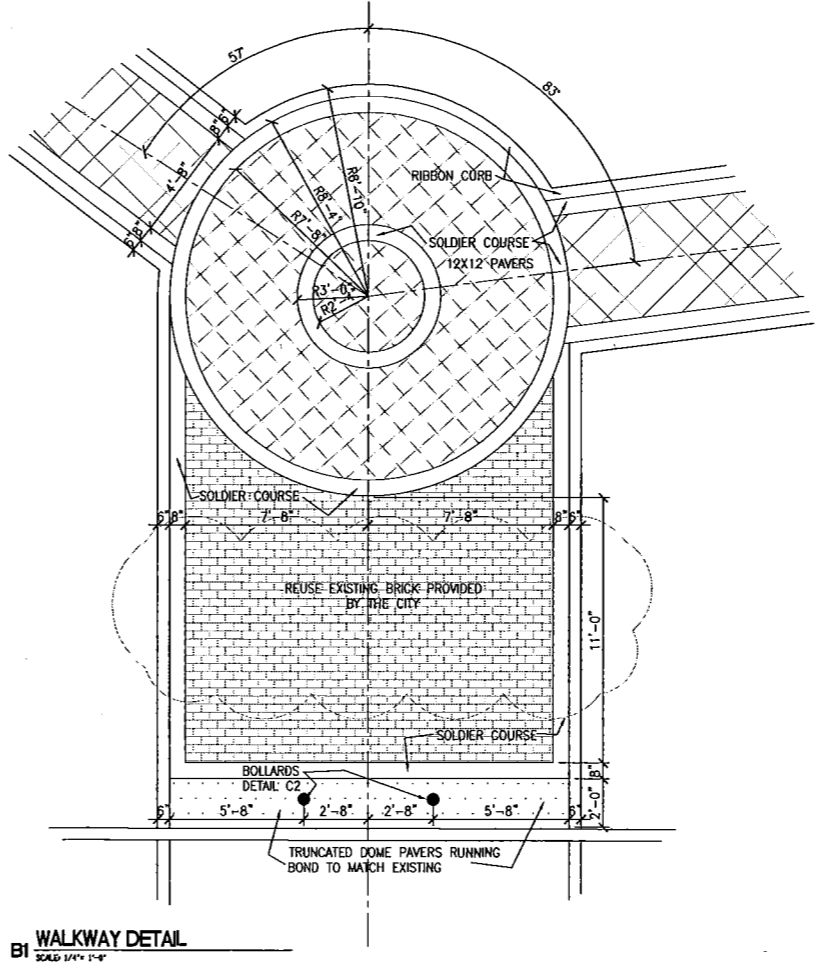
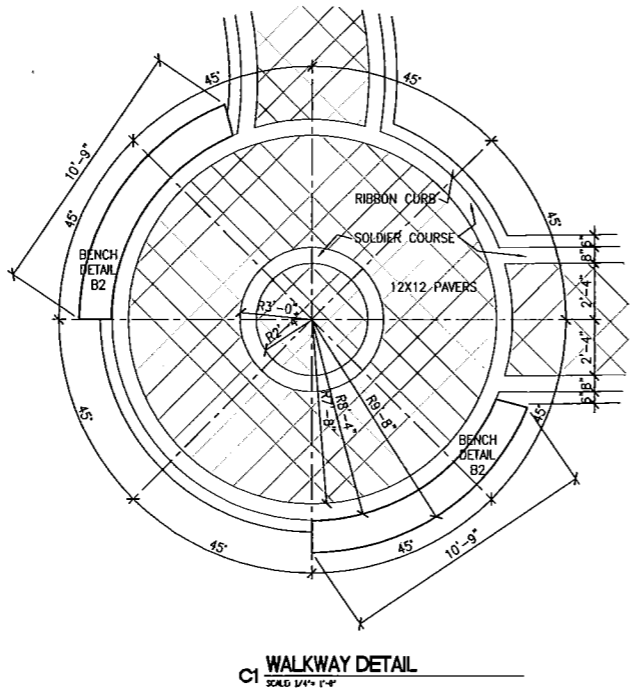
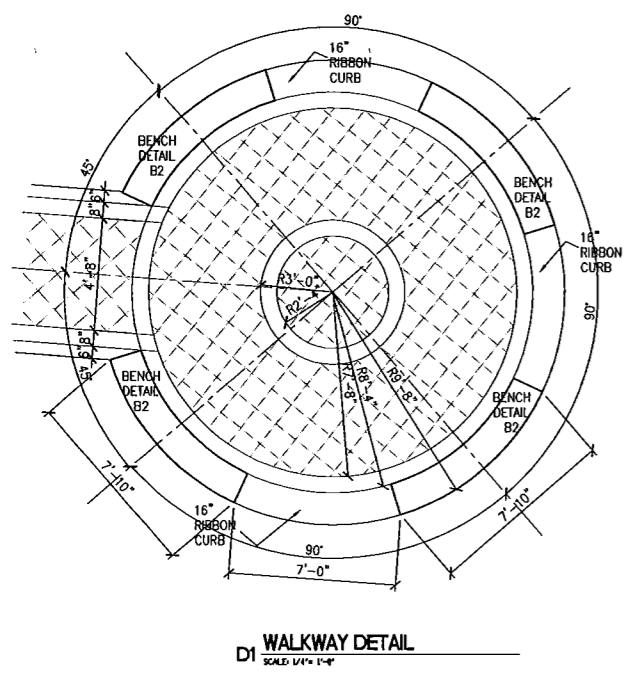
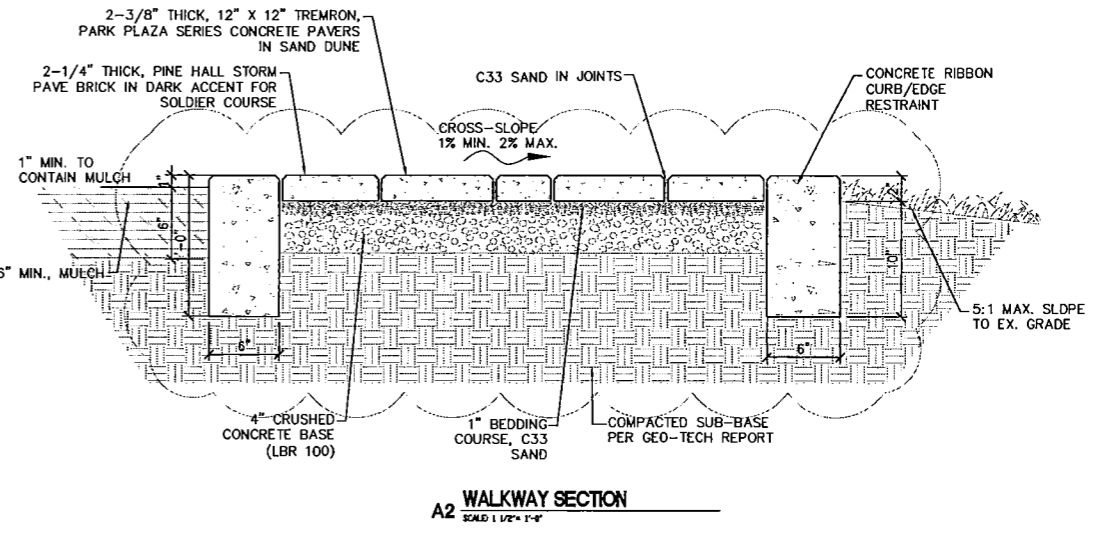
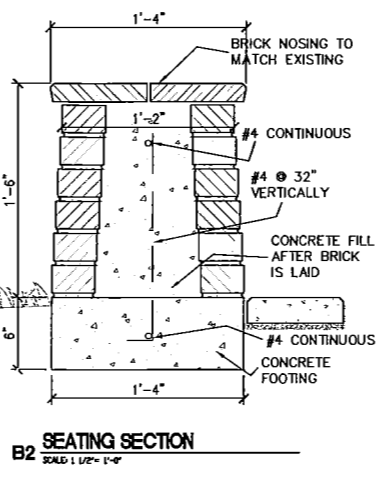
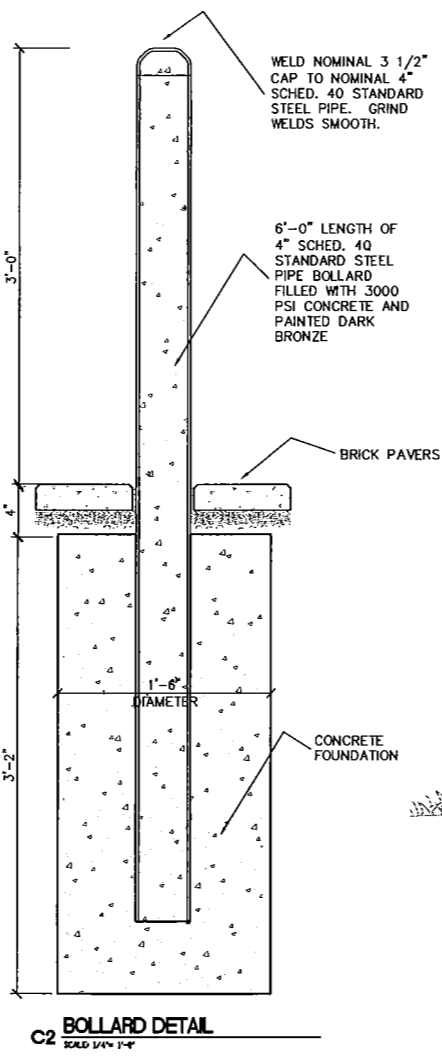
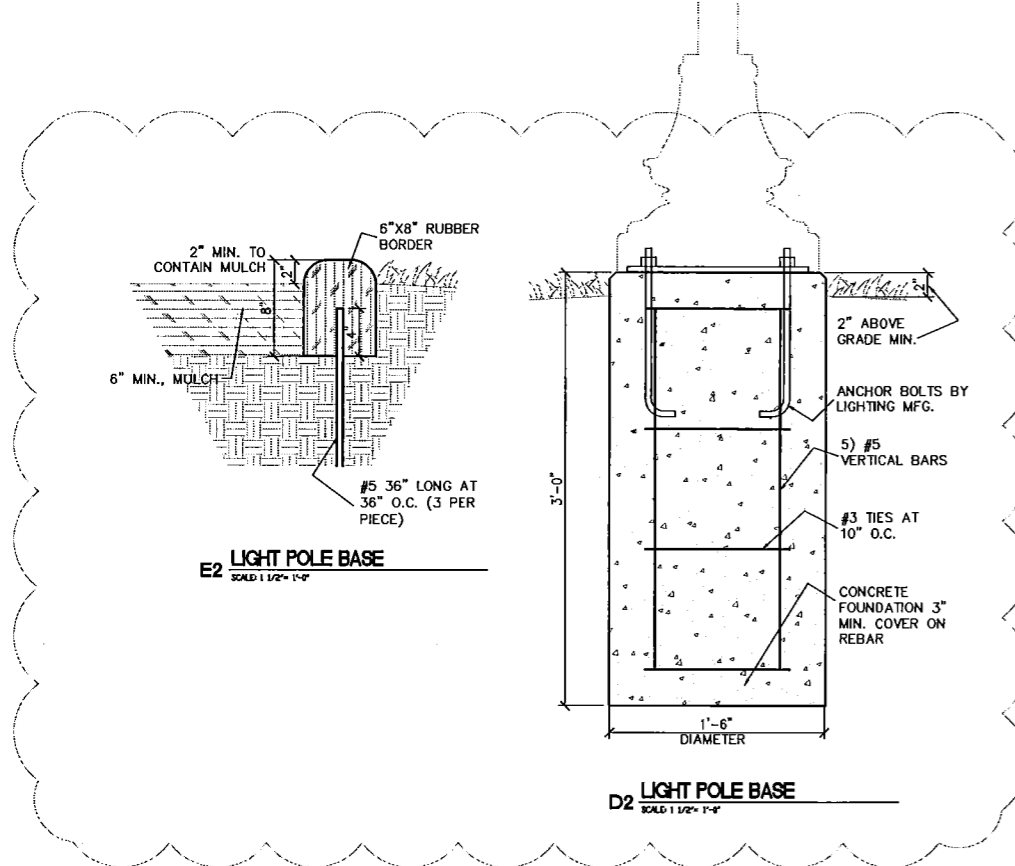

PRELIMINARY NOT FOR CONSTRUCTION

PLAYGROUND DETAILS
SUTTON PARK RESTROOMS
PALMETTO, FL

Moore 2 Design
ARCHITECTURE - INTERIOR DESIGN
Architect: Jon L. Moore, AIA AR26001330
Phone: 941.729.1229 Fax: 941.729.5979
706 Riverside Drive Palmetto, FL 34221
COPYRIGHT MOORE 2 DESIGN, LLC. ALL RIGHTS RESERVED.

NO.	DATE	REVISION DESCRIPTION
1	08.12.12	ISSUE DATE
2	08.14.12	DETAIL UPDATE
3	08.30.12	DESIGN UPDATE
4		
5		

SHEET NO. **A-102-P**
PROJECT NO. DATE 06/27/2012
1208